



VT BATTERY TORQUE WRENCH



www.appliedtorque.co.uk

VT

BATTERY TORQUE WRENCH

THE WRENCH THAT CHANGED EVERYTHING

ENGINEERED TO MASTER ANY APPLICATION EFFORTLESSLY, YOUR ABILITY TO TORQUE INDUSTRIAL FASTENERS IS A SIMPLE AND QUICK CHARGE AWAY. FULLY CHARGED IN UNDER 60 MINUTES, THE VOLTA'S LITHIUM POWER WILL PROVIDE YOU WITH THE CAPABILITY TO TORQUE HUNDREDS OF FASTENINGS WITH NO HOSES OR CORDS TO LIMIT YOUR REACH. WITHIN THE VOLTA IS A DIGITAL MOTOR VECTORING SYSTEM THAT PROVIDES ACCURATE AND REPEATABLE TORQUE THROUGHOUT EACH MODEL'S FULL RANGE. THE VOLTA EXEMPLIFIES THE DURABILITY, RELIABILITY AND SAFETY THAT HAS EMBODIED EVERY INDUSTRIAL WRENCH CRAFTED BY TORCUP SINCE THE COMPANY'S FOUNDING IN 1996.



THE POWER INSIDE

1. HARDENED ALLOY STEEL FOR DURABILITY AND LONG CYCLE LIFE
2. BEARINGS SUPPORT THE LOADS EXPERIENCED AT THE SQUARE DRIVE
3. MULTI-STAGE PLANETARY GEAR SYSTEMS WITH OPTIMIZED TOOTH DESIGN
4. SMOOTH BALL BEARING ROTATION OF THE GEARBOX HOUSING INDEPENDENT FROM THE MOTOR HANDLE
5. HIGH-EFFICIENCY BRUSHLESS MOTOR
6. ERGONOMIC GLASS-FILLED NYLON HANDLE WITH A DURABLE SLIP-RESISTANT OVERMOLD
7. 18V 7.0 AH LIHD BATTERY THAT PROVIDES EXTENDED RUN-TIME
8. LCD DISPLAY FOR SETTING AND VIEWING TORQUE AND UNITS
9. SOFT-START TRIGGER
10. THRUST BEARING BETWEEN STAGES ISOLATE THE MOTOR WHEN USED IN ALL ORIENTATIONS
11. O-RINGS SEAL GREASE IN WHILE KEEPING DIRT AND WATER OUT
12. GEARS RUN ON LOW FRICTION, HIGH STRENGTH BEARING SLEEVES
13. TOOL STEEL PINS IN EACH STAGE CARRIER

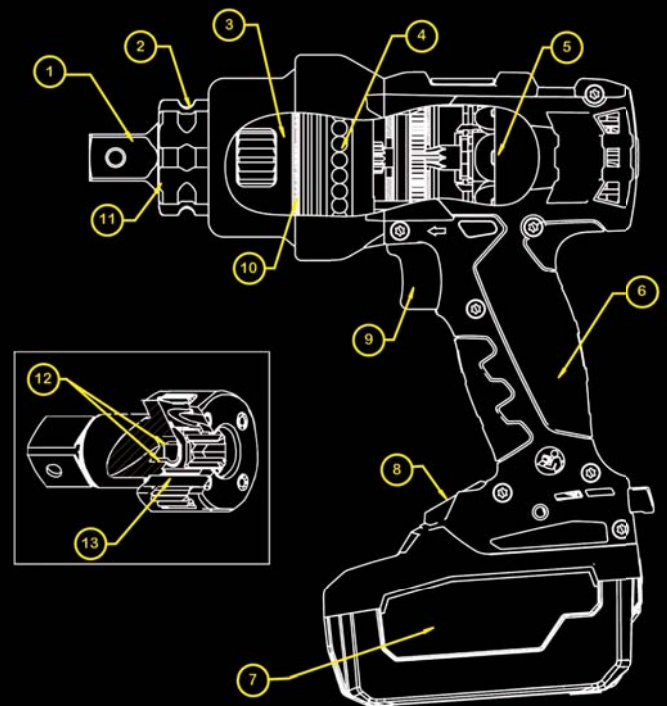



VT-500 SINGLE SPEED
TORQUE RANGE 120-500 FT/LBS
FREE SPEED 12-20 RPM

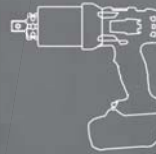

VT-1000 SINGLE SPEED
TORQUE RANGE 240-1000 FT/LBS
FREE SPEED 2-8 RPM

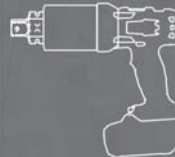

VT-2000 SINGLE SPEED
TORQUE RANGE 500-2000 FT/LBS
FREE SPEED 1-5 RPM

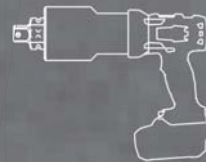

VT-3000 SINGLE SPEED
TORQUE RANGE 750-3000 FT/LBS
FREE SPEED 0.5-2 RPM

Charger Requirements: 110 - 120 V (50-60 Hz)
 and 230 - 240 V (50-60 Hz)

www.appliedtorque.co.uk

POWER ENGINEERED

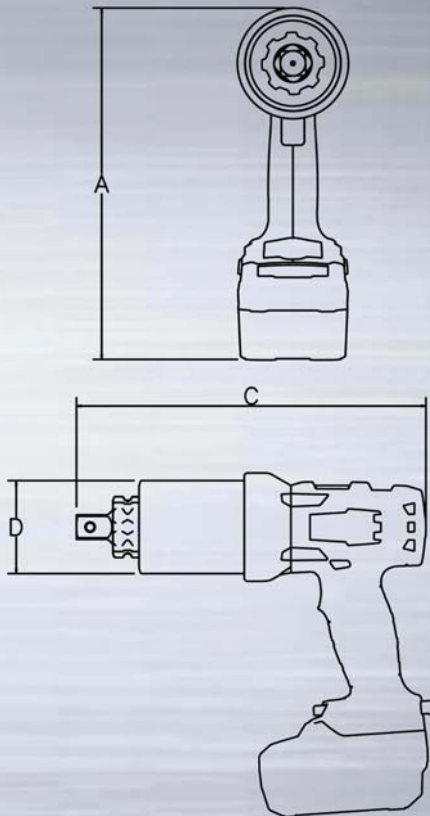

| MODEL NUMBER | VT-500 | VT-1000 | VT-2000 | VT-3000 |
|---|--------|---------|---------|---------|
| SQUARE DRIVE | 3/4" | 1" | 1" | 1" |
| MIN. TORQUE (ft/lbs) | 120 | 240 | 500 | 750 |
| MAX TORQUE (ft/lbs) | 500 | 1000 | 2000 | 3000 |
| MIN. TORQUE (Nm) | 160 | 330 | 680 | 1020 |
| MAX TORQUE (Nm) | 670 | 1350 | 2710 | 4030 |
| HEIGHT A (w/ battery) (in) | 10.40" | 10.40" | 10.40" | 10.40" |
| HEIGHT A (w/ battery) (mm) | 265 | 265 | 265 | 265 |
| LENGTH C (in) | 8.86" | 10.97" | 11.45" | 13.94" |
| LENGTH C (mm) | 225 | 279 | 291 | 355 |
| DIAMETER D (in) | 2.56" | 2.85" | 3.09" | 3.75" |
| DIAMETER D (mm) | 65 | 72.4 | 78.5 | 95.3 |
| WEIGHT (w/o reaction arm & battery) (lbs) | 8.3 | 11.5 | 13.1 | 19.6 |
| WEIGHT (w/o reaction arm & battery) (kg) | 3.8 | 5.2 | 5.9 | 8.9 |
| WEIGHT (w/ reaction arm & battery) (lbs) | 10.4 | 14.5 | 15.9 | 22.5 |
| WEIGHT (w/ arm & battery) (kg) | 4.7 | 6.6 | 7.2 | 10.2 |
| RPM at Min. Torque | 12 | 2 | 1 | 0.5 |
| RPM at Max Torque | 20 | 8 | 5 | 2 |

www.appliedtorque.co.uk



VT

SERIES
BATTERY-POWERED
TORQUE WRENCH

PORTABLE - LITHIUM BATTERY POWER

UNIVERSAL - GLOBAL CHARGING PLATFORM

REPEATABLE - HIGH-EFFICIENCY BRUSHLESS MOTOR

SLIDING STRAIGHT
REACTION ARM



STRAIGHT
REACTION ARM



LONG EXTENDED
REACTION ARM



NOSE
EXTENSION



VOLTA CHARGER



VOLTA BATTERY



torqueUP

Applied Torque Systems
Unit S Trecenydd Ind Est
Caerphilly
CF83 2RZ
Tel: 02920 888883

www.appliedtorque.co.uk

TOOL
CARRYING
CASE



CHARGER
CARRYING
CASE



www.appliedtorque.co.uk