



PNEUTORQUE® STANDARD SERIES



Based on the original PneuTorque®, the 'Standard Series' range is a direct result of over 50 years of refinement and development necessary to keep pace with the requirements of industry today.

In use in many thousands of applications worldwide PneuTorque® wrenches continue to represent the foundation of Norbar's powered tool range. Two speed models offer all the advantages of single speed versions but with the additional benefit of a run-down speed five times greater than the high torque speed setting.

- Models available for almost every bolting and torque application, up to 300,000 N·m
- Forward and reverse operation
- Quiet, non-impacting or pulsing operation - low operator fatigue
- Stall control gives repeatability of ±5% on a given joint
- Other reaction styles can be designed to suit specific applications
- Electronic torque transducers can be fitted for precise torque monitoring

11	TO 100000 N·m - SINGLE SPEED
16031	PT 1 ¾" sq. dr. 160-680 N·m, 120-500 lbf-ft
16011	PT 1 1" sq. dr. 160-680 N·m, 120-500 lbf-ft
16098	PT 1A ¾" sq. dr. 270-1200 N·m, 200-900 lbf-ft
16097	PT 1A 1" sq. dr. 270-1200 N·m, 200-900 lbf-ft
16013	PT 2 1" sq. dr. 515-1700 N·m, 380-1250 lbf-ft
16015	PT 5 1" sq. dr. 880-3400 N·m, 650-2500 lbf-ft
16017	PT 6 1½" sq. dr. 880-3400 N·m, 650-2500 lbf-ft
16066	PT 7 1½" sq. dr. 1762-6000 N·m, 1300-4500 lbf-ft
16072	PT 9 1½" sq. dr. 2710-9500 N·m, 2000-7000 lbf-ft
16046	PT 11 2½" sq. dr. 4400-20000 N·m, 3250-14700 lbf-ft
18086	PT 12 2½" sq. dr. 9500-34000 N·m, 7000-25000 lbf-ft
16052	PT 13 2½" sq. dr. 13550-47000 N·m, 10000-35000 lbf-ft
16045	PT 14 3½" sq. dr. 22375-100000 N·m, 16500-73500 lbf-ft

11	TO 9500 N·m - AUTOMATIC TWO SPEED
16031.AUT	PT 1 ¾" sq. dr. Auto 2SP 160-680 N·m, 120-500 lbf-ft
16011.AUT	PT 1 1" sq. dr. Auto 2SP 160-680 N·m, 120-500 lbf-ft
16098.AUT	PT 1A ¾" sq. dr. Auto 2SP 400-1200 N·m, 295-900 lbf-ft
16097.AUT	PT 1A 1" sq. dr. Auto 2SP 400-1200 N·m, 295-900 lbf-ft
16013.AUT	PT 2 1" sq. dr. Auto 2SP 700-1700 N·m, 516-1250 lbf-ft
16015.AUT	PT 5 1" sq. dr. Auto 2SP 880-3400 N·m, 650-2500 lbf-ft
16017.AUT	PT 6 1½" sq. dr. Auto 2SP 880-3400 N·m, 650-2500 lbf-ft
16066.AUT	PT 7 1½" sq. dr. Auto 2SP 2200-6000 N·m, 1622-4500 lbf-ft
16072.AUT	PT 9 1½" sq. dr. Auto 2SP 2100-9500 N·m, 2286-7000 lbf-ft

MTS = Manual Two Speed. Auto 2SP = Automatic Two Speed.
Angle Encoders are available for standard series PTs please contact Norbar for further details.

NB: PneuTorque® PT 11 - PT 18 are supplied with a Lubro Control Unit as standard equipment. PneuTorques PT 12, 13 and 14 are also supplied with a weld prepared reaction ring as standard. PTs 13 and 14 are also supplied with a transporting trolley. PTs 15 - 18 do not include output drive or reaction. These components will be engineered uniquely for each application. Remote PT part numbers are designated with an .X

e.g. PT 1 Remote is 16031.X
e.g. PT 1 Remote Auto is 16031.XAUT

11	TO 300000 N·m - MANUAL TWO SPEED
16031.MTS	PT 1 ¾" sq. dr. MTS 160-680 N·m, 120-500 lbf-ft
16011.MTS	PT 1 1" sq. dr. MTS 160-680 N·m, 120-500 lbf-ft
16098.MTS	PT 1A ¾" sq. dr. MTS 270-1200 N·m, 200-900 lbf-ft
16097.MTS	PT 1A 1" sq. dr. MTS 270-1200 N·m, 200-900 lbf-ft
16013.MTS	PT 2 1" sq. dr. MTS 515-1700 N·m, 380-1250 lbf-ft
16015.MTS	PT 5 1" sq. dr. MTS 880-3400 N·m, 650-2500 lbf-ft
16017.MTS	PT 6 1½" sq. dr. MTS 880-3400 N·m, 650-2500 lbf-ft
16066.MTS	PT 7 1½" sq. dr. 1762-6000 N·m, 1300-4500 lbf-ft
16072.MTS	PT 9 1½" sq. dr. 2710-9500 N·m, 2000-7000 lbf-ft
16046.MTS	PT 11 2½" sq. dr. 4400-20000 N·m, 3250-14700 lbf-ft
18086.MTS	PT 12 2½" sq. dr. 9500-34000 N·m, 7000-25000 lbf-ft
16052.MTS	PT 13 2½" sq. dr. 13550-47000 N·m, 10000-35000 lbf-ft
16045.MTS	PT 14 3½" sq. dr. 22375-100000 N·m, 16500-73500 lbf-ft
18089.MTS	PT 15 MTS 40000-150000 N·m, 29500-110500 lbf-ft
18090.MTS	PT 16 MTS 55000-200000 N·m, 40500-147500 lbf-ft
18088.MTS	PT 17 MTS 70000-250000 N·m, 51500-184500 lbf-ft
16054.MTS	PT 18 MTS 85000-300000 N·m, 62500- 221500 lbf-ft
16490	Lifting Bracket for Standard Series (up to PT7)



PT 18 fitted with Annular Transducer
(Transducer not included)

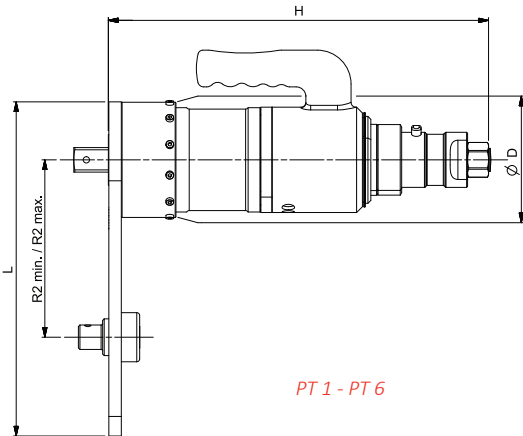

PT 1 - PT 6

PneuTorque® Standard Series Automatic Two Speed

Model	PT 1	PT 1A	PT 2	PT 5	PT 6	PT 7	PT 9
Part Number/s	16031.AUT 16011.AUT	16098.AUT 16097.AUT	16013.AUT	16015.AUT	16017.AUT	16066.AUT	16072.AUT
Output Speed (rpm)	150	75	45	25	25	12.5	9
Dimensions (mm)	ØD	108	108	108	119	119	144
	H	419	419	419	462	464	492
	L	303	303	303	355	355	423
	R1	N/A	N/A	N/A	N/A	N/A	84
	R2 min.	83	83	83	86	86	150
	R2 max.	216	216	216	263	263	331
Tool Weight (kg)	14.1	14.6	14.6	17.5	17.5	23.2	27.9
Reaction Weight (kg)	2.2	2.2	2.2	2.5	2.5	6.3	8.3

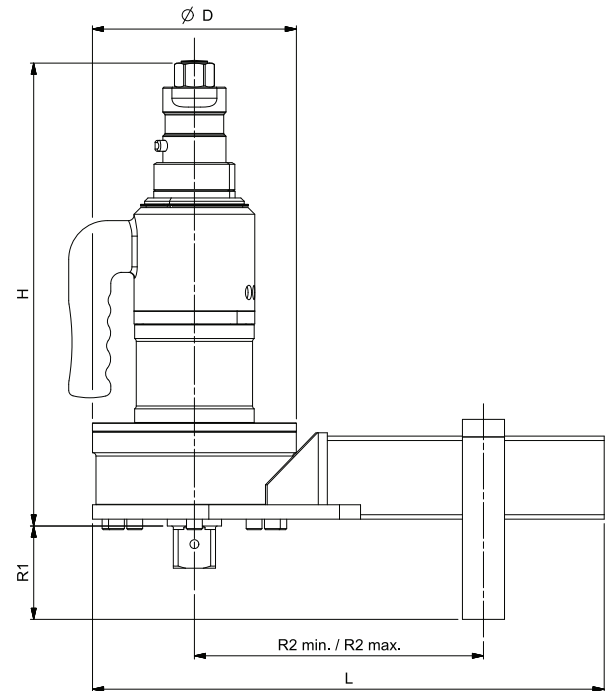

PT 7 - PT 11

PneuTorque® Standard Series Single Speed

Model	PT 1	PT 1A	PT 2	PT 5	PT 6	PT 7	PT 9	PT 11	PT 12	PT 13	PT 14
Part Number/s	16031 16011	16098 16097	16013	16015	16017	16066	16072	16046	18086	16052	16045
Output Speed (rpm)	30	15	9	5	5	2.5	1.8	1.2	0.5	0.3	0.2
Dimensions (mm)	ØD	108	108	108	119	119	144	184	212	248	315
	H	350	350	350	393	395	423	418	495	536	578
	L	303	303	303	355	355	423	448	609	325	341
	R1	N/A	N/A	N/A	N/A	N/A	84	84	N/A	N/A	N/A
	R2 min.	83	83	83	86	86	150	175	320	N/A	N/A
	R2 max.	216	216	216	263	263	331	351	500	N/A	N/A
Tool Weight (kg)	10.6	11.1	11.1	14	14	19.7	24.4	38.6	49.8	102.2	119.4
Reaction Weight (kg)	2.2	2.2	2.2	2.5	2.5	6.3	8.3	13.3	6.5	6.9	10.4

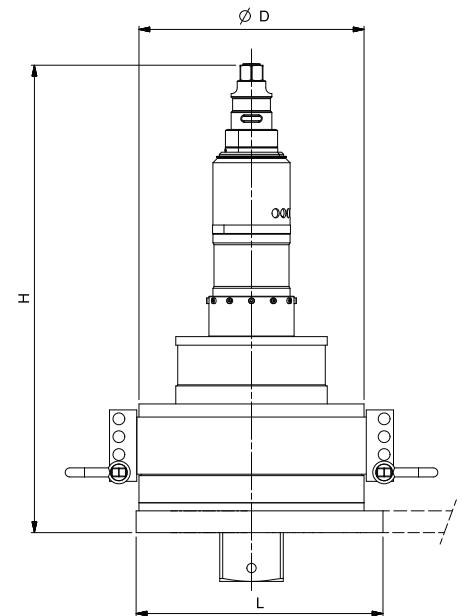

PT 12 - PT 18

PneuTorque® Standard Series Manual Two Speed

Model	PT 1	PT 1A	PT 2	PT 5	PT 6	PT 7	PT 9	PT 11	PT 12	PT 13	PT 14	PT 15	PT 16	PT 17	PT 18	
Part Number/s	16031.MTS 16011.MTS	16098.MTS 16097.MTS	16013.MTS	16015.MTS	16017.MTS	16066.MTS	16072.MTS	16046.MTS	18086.MTS	16052.MTS	16045.MTS	18089.MTS	18090.MTS	18088.MTS	16054.MTS	
Output Speed (rpm)	150	75	45	25	25	12.5	9	6	2.5	1.5	1	0.5	0.4	0.35	0.3	
Dimensions (mm)	ØD	108	108	108	119	119	144	184	212	248	315	315	*	410	410	520
	H	436	436	436	479	481	509	504	581	622	664	729	*	866	939	936
	L	303	303	303	355	355	423	448	609	325	341	341	*	N/A	N/A	N/A
	R1	N/A	N/A	N/A	N/A	N/A	84	84	N/A	N/A	N/A	N/A	N/A	N/A	N/A	N/A
	R2 min.	83	83	83	86	86	150	175	320	N/A	N/A	N/A	N/A	N/A	N/A	N/A
	R2 max.	216	216	216	263	263	331	351	500	N/A	N/A	N/A	N/A	N/A	N/A	N/A
Tool Weight (kg)	14.1	14.6	14.6	17.5	17.5	23.2	27.9	42.1	53.3	105.7	122.9	*	270	285	380	
Reaction Weight (kg)	2.2	2.2	2.2	2.5	2.5	6.3	8.3	13.3	6.5	6.9	10.4	N/A	N/A	N/A	N/A	

* Available on request



PNEUTORQUE® STANDARD SERIES

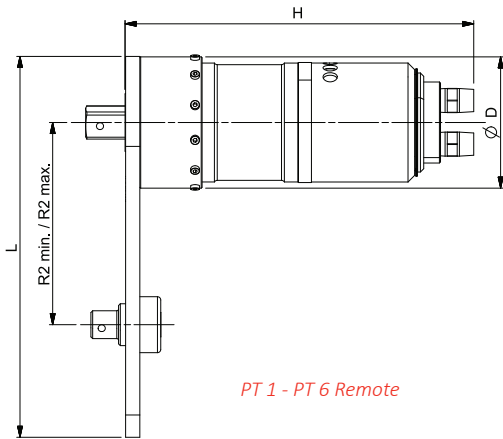

PT 1 - PT 6 Remote

PneuTorque® Standard Series Automatic Two Speed - Remote

Model	PT 1	PT 1A	PT 2	PT 5	PT 6	PT 7	PT 9	
Part Number/s	16031.XAUT 16011.XAUT	16098.XAUT 16097.XAUT	16013.XAUT	16015.XAUT	16017.XAUT	16066.XAUT	16072.XAUT	
Output Speed (rpm)	150	75	45	25	25	12.5	9	
Dimensions (mm)	ØD	108	108	108	119	119	144	184
	H	339	339	339	382	383	412	407
	L	303	303	303	355	355	423	448
	R1	N/A	N/A	N/A	N/A	N/A	84	84
	R2 min.	83	83	83	86	86	150	175
	R2 max.	216	216	216	263	263	331	351
Tool Weight (kg)	14.1	14.6	14.6	17.5	17.5	23.2	27.9	
Reaction Weight (kg)	2.2	2.2	2.2	2.5	2.5	6.3	8.3	

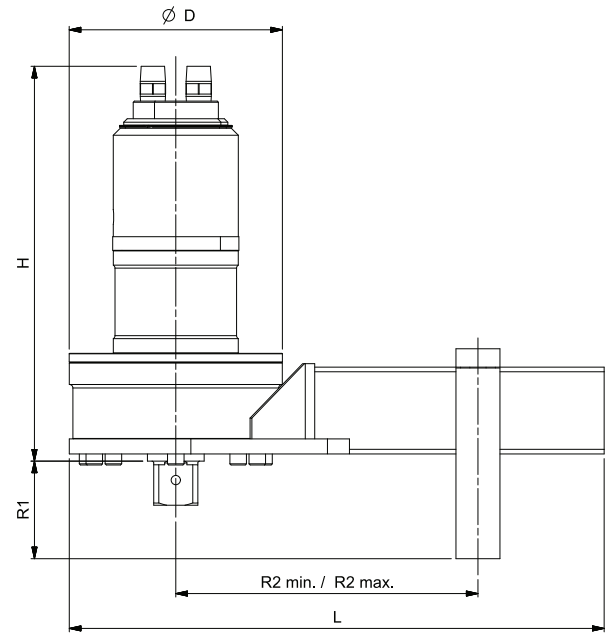

PT 7 - PT 11 Remote

PneuTorque® Standard Series Single Speed - Remote

Model	PT 1	PT 1A	PT 2	PT 5	PT 6	PT 7	PT 9	PT 11	PT 12	PT 13	PT 14	
Part Number/s	16031.X 16011.X	16098.X 16097.X	16013.X	16015.X	16017.X	16066.X	16072.X	16046.X	18086.X	16052.X	16045.X	
Output Speed (rpm)	30	15	9	5	5	2.5	1.8	1.2	0.5	0.3	0.2	
Dimensions (mm)	ØD	108	108	108	119	119	144	184	212	248	315	315
	H	270	270	270	313	314	343	340	415	456	490	563
	L	303	303	303	355	355	423	448	609	325	341	341
	R1	N/A	N/A	N/A	N/A	N/A	84	84	N/A	N/A	N/A	N/A
	R2 min.	83	83	83	86	86	150	175	320	N/A	N/A	N/A
	R2 max.	216	216	216	263	263	331	351	500	N/A	N/A	N/A
Tool Weight (kg)	10.6	11.1	11.1	14	14	17.9	24.4	38.6	49.8	102.2	119.4	
Reaction Weight (kg)	2.2	2.2	2.2	2.5	2.5	6.3	8.3	13.3	6.5	6.9	10.4	

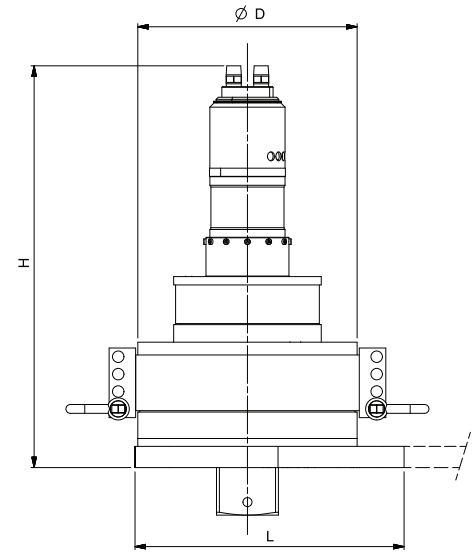

PT 12 - PT 18 Remote

PneuTorque® Standard Series Manual Two Speed - Remote

Model	PT 1	PT 1A	PT 2	PT 5	PT 6	PT 7	PT 9	PT 11	PT 12	PT 13	PT 14	PT 15	PT 16	PT 17	PT 18	
Part Number/s	16031.XMSTS 16011.XMSTS	16098.XMSTS 16097.XMSTS	16013.XMSTS	16015.XMSTS	16017.XMSTS	16066.XMSTS	16072.XMSTS	16046.XMSTS	18086.XMSTS	16052.XMSTS	16045.XMSTS	18089.XMSTS	18090.XMSTS	18088.XMSTS	16054.XMSTS	
Output Speed (rpm)	150	75	45	25	25	12.5	9	6	2.5	1.5	1	0.5	0.4	0.35	0.3	
Dimensions (mm)	ØD	108	108	108	119	119	144	184	212	248	315	315	*	410	410	520
	H	356	356	356	399	400	429	425	501	542	576	649	*	786	859	856
	L	303	303	303	355	355	423	448	609	325	341	341	*	N/A	N/A	N/A
	R1	N/A	N/A	N/A	N/A	N/A	84	84	N/A	N/A	N/A	N/A	N/A	N/A	N/A	N/A
	R2 min.	83	83	83	86	86	150	175	320	N/A	N/A	N/A	N/A	N/A	N/A	N/A
	R2 max.	216	216	216	263	263	331	351	500	N/A	N/A	N/A	N/A	N/A	N/A	N/A
Tool Weight (kg)	14.1	14.6	14.6	17.5	17.5	23.2	27.9	42.1	53.3	105.7	122.9	*	270	285	380	
Reaction Weight (kg)	2.2	2.2	2.2	2.5	2.5	6.3	8.3	13.3	6.5	6.9	10.4	N/A	N/A	N/A	N/A	

* Available on request



11	NOSE EXTENSIONS FOR STANDARD SERIES GEARBOX
16480.006	PT1 & 2, 6" long, F/M ¾" sq. dr.
16480.009	PT1 & 2, 9" long, F/M ¾" sq. dr.
16480.012	PT1 & 2, 12" long, F/M ¾" sq. dr.
16542.006	PT1 & 2, 6" long, F/M 1" sq. dr.
16542.009	PT1 & 2, 9" long, F/M 1" sq. dr.
16542.012	PT1 & 2, 12" long, F/M 1" sq. dr.
16694.006	PT5 6" long, M/M 1" sq. dr.
16694.009	PT5 9" long, M/M 1" sq. dr.
16694.012	PT5 12" long, M/M 1" sq. dr.

The nose extensions shown above can also be used with HT2s and 5s.
 If required other sizes of nose extension are available.
 F/M = Female input square/male output square
 M/M = Male input square/male output square

11	FOR HT30/PT2700
16686	Single Sided Straight Reaction Plate



Sliding Spigot Reaction Plate (18436)

11	FOR HT60/PT4500/PT5500
16687	Single Sided Straight Reaction Plate
18436	Sliding Spigot Reaction Plate

LUBRO CONTROL UNITS



16074



16075



60290

Norbar's standard filter, regulator, lubricator unit 16074 features a 100mm diameter gauge for easy and accurate setting of air pressure with ergonomic placement of air pressure adjustment control. It is supplied with 3 metres of robust, steel braded air hose with fittings to connect to PneuTorque® wrenches.

Twin Regulator Lubro Control Unit, part number 16075

The 'Twin Lubro' has the same features as Norbar's standard filter, regulator, lubricator unit but has the benefit of two regulators and a switch that allows quick selection between two air pressure settings. A typical application for this would be a PneuTorque® user wishing to quickly select between two applications requiring different torque settings. For example, this might be controlled torque in the forward direction and maximum torque allowed by the tool in the reverse direction.

Multi Channel Lubro, part number 60290

The Multi Channel Lubro is for users who wish to run their pneumatic tools at multiple air pressure settings, without having to make time consuming adjustments to an air regulator. The Multi Channel Lubro can be programmed for up to 15 air pressure settings and these settings can be locked by the removal of the programming key. A typical application would be a tyre shop servicing various vehicles, each vehicle having a different wheel nut torque. Settings can be recorded on a write-on label situated on the front of the Lubro Control. The Multi Channel Lubro is battery powered with a battery life of approximately 16 hours under normal use.

11	LUBRO CONTROL UNITS
16074	Lubro Control Unit F/W 3m hose
16075	Twin Lubro Control Unit
60290	Multi Channel Lubro

See Page 112 for Lubro Control Unit spares.